

••AVAILABLE FOR LEASE••  
**HIGH VISIBILITY GREENWICH RETAIL SPACE**

14 RAILROAD AVENUE, GREENWICH, CT  
(METRO-NORTH STATION RETAIL PLAZA)



**Currently Occupied by Kid's Supply Co.**

**SIZE: RETAIL: 2,036 Sq. Ft.**

**LOWER LEVEL: 1,257 Sq. Ft.**

**RENT: Upon Request**

**FRONTAGE: 27' (Ceiling Height 12')**

**PARKING: Gated Parking Lot for 38 Cars**

**LOCATION: Between Citibank and  
Hopscotch Salon**

**For Further Details Contact:**

**Matthew Bernard, Exclusive Broker**



14 Railroad Avenue. Interior Photos: Retail Level



71 Arch Street

Greenwich, Connecticut 06830

phone 203-622-1636

fax 203-622-1981



14 Railroad Avenue: Lower Level



**Floor Plan: Retail Store and Basement, 14 Railroad Avenue, Greenwich, CT**

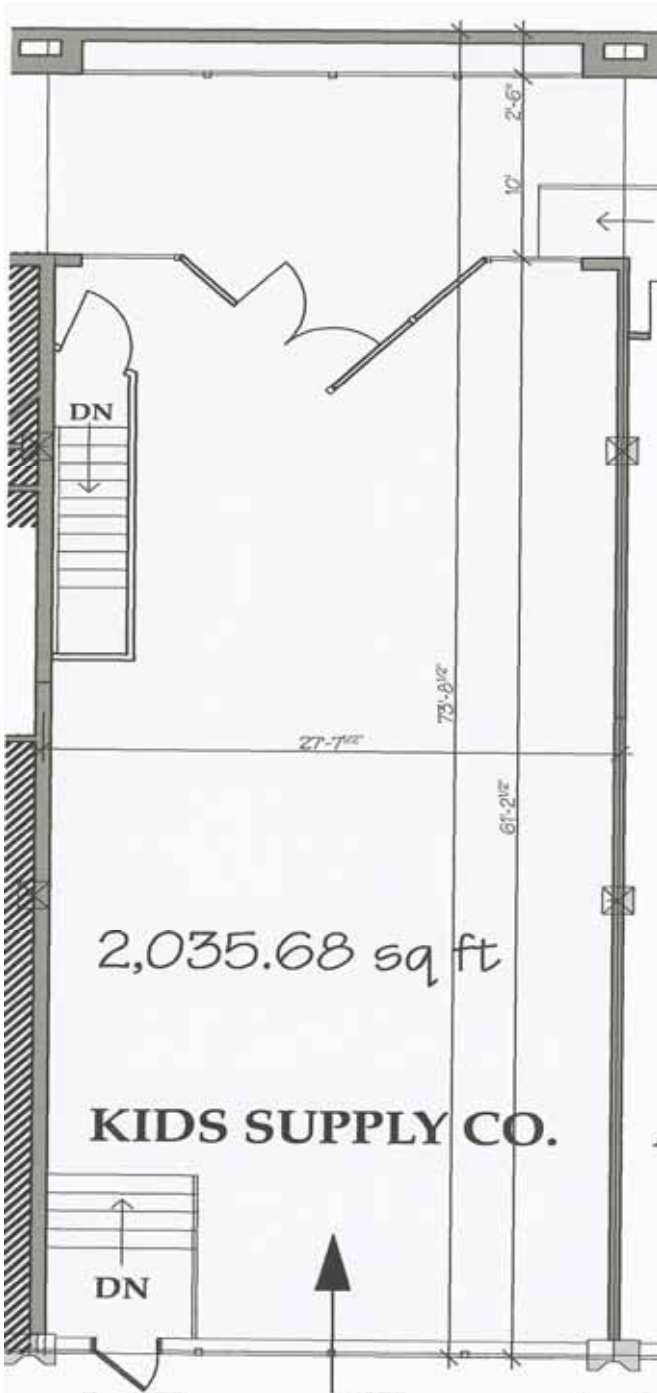

**Railroad Avenue Store Entrance**



**Basement Plan**

# RAILROAD STATION RETAIL PLAZA, GREENWICH, CT

38 CAR RESERVED RETAIL CUSTOMER PARKING

Railroad Avenue

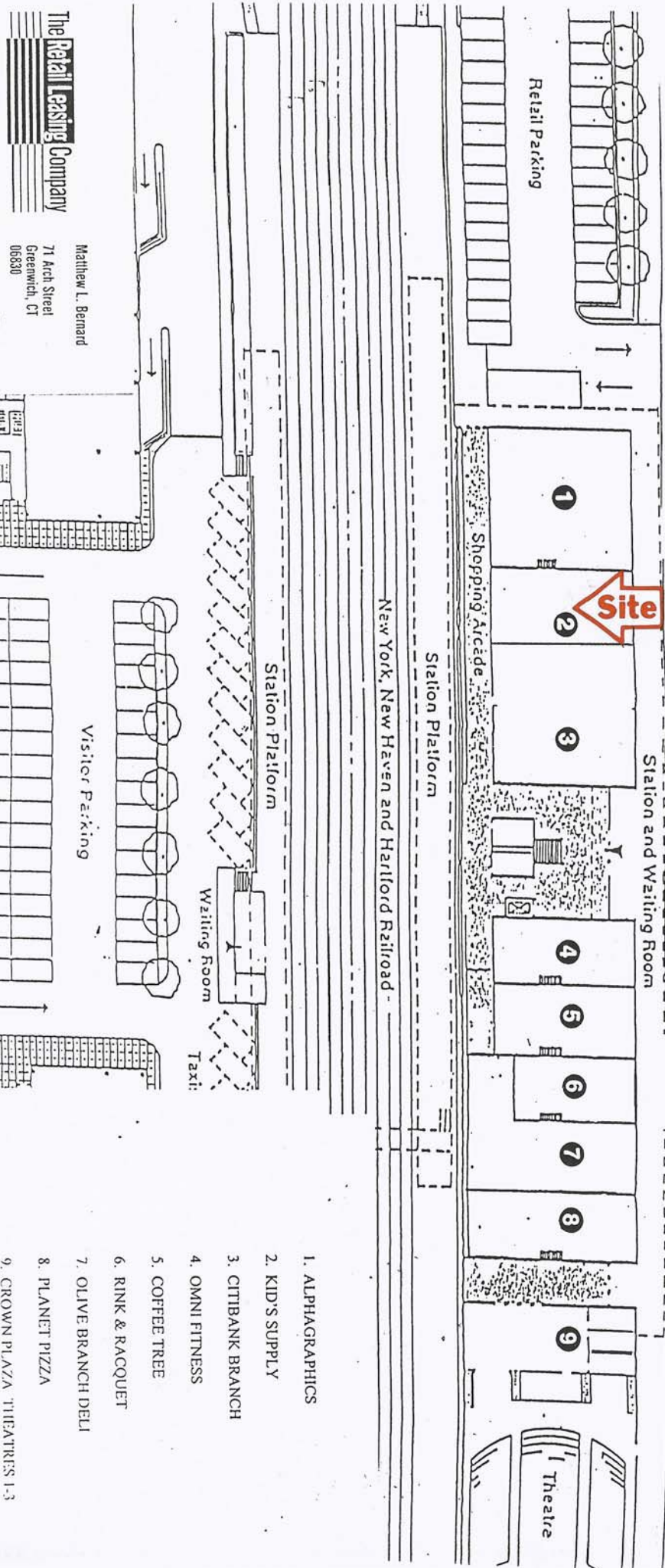

- 1. ALPHAGRAPHICS
- 2. KID'S SUPPLY
- 3. CITIBANK BRANCH
- 4. OMNI FITNESS
- 5. COFFEE TREE
- 6. RINK & RACQUET
- 7. OLIVE BRANCH DELI
- 8. PLANET PIZZA
- 9. CROWN PLAZA THEATRES 1-3

**The Retail Leasing Company**  
 Matthew L. Bernard  
 71 Arch Street  
 Greenwich, CT  
 06830